

**NOTES:**

1. WATERMAIN TO HAVE A MINIMUM SEPARATION FROM SEWERS OF 2.5m HORIZONTAL OR 0.5m VERTICAL WHERE PROPER SEPARATION FROM SEWERS CAN NOT BE ACHIEVED. WATERMANS ARE TO BE CONCRETE ENCASED, AS DIRECTED.
2. RECONNECT EXISTING WATER, SANITARY AND STORM SERVICES, AS REQUIRED. EXACT LOCATION OF SERVICES TO BE DETERMINED AT TIME OF CONSTRUCTION.

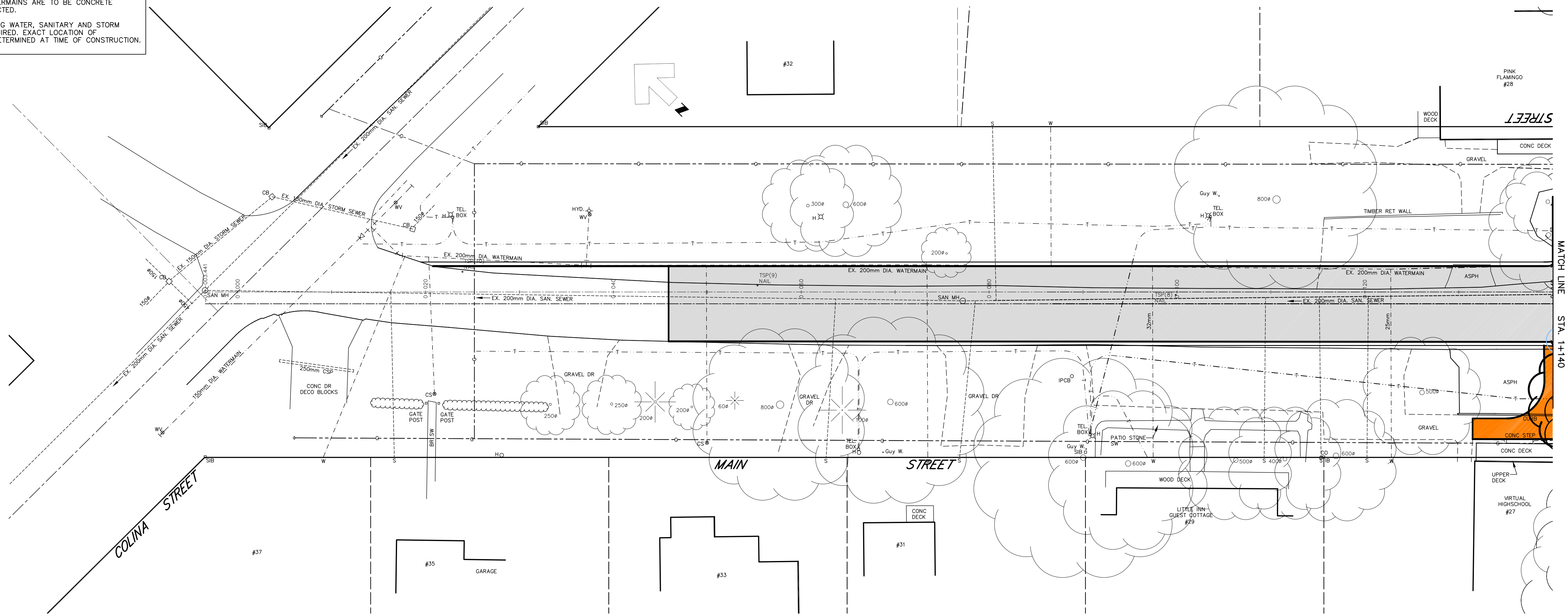

**LEGEND**

SAN. or STM.	EXISTING SEWERS, SANITARY or STORM
MH, CB	MANHOLE and CATCHBASIN
W	WATERMAIN
---	UNDERGROUND TELEPHONE
---	UNDERGROUND HYDRO
---	UNDERGROUND T.V. CABLE
H, B, T, H-B, L, X	UTILITY POLES
---	GRUBBING
---	REMOVE EXISTING CONC. SIDEWALK AND DRIVES
---	REMOVE AND PLACE CONC. SIDEWALK AND DRIVES
---	PLACE CONC. SIDEWALK AND DRIVES
---	REMOVE EXISTING ASPHALT PAVT
---	PLACE HOT MIX ASPHALT DRIVES 60mm H.C. HOT MIX (MBC)
---	REMOVE EXISTING CONC. CURB

**NOTE**  
The locations of existing underground utilities are shown in an approximate way only and have not been independently verified by the owner or its representative. The contractor shall determine the exact location of all existing utilities before commencing work and agrees to be fully responsible for any damages which might be occasioned by the contractor's failure to exactly locate and preserve any and all underground utilities.

**BENCHMARK INFORMATION**

?	?
?	?
?	?

Design By: JY      Checked By: DLA

PRELIMINARY

No.	DATE	REVISION
1	April 20, 2015	Council Presentation
2	Oct. 19, 2016	Public Open House



Goderich (519) 524-2641      Mount Forest (519) 323-2945



**Municipality of Bluewater**  
**Main Street**  
**Road Reconstruction**  
Plan and Profile  
From Sta. 0+000 to Sta. 0+140

<b>Project No.</b> 14106
<b>Drawing No.</b> 1

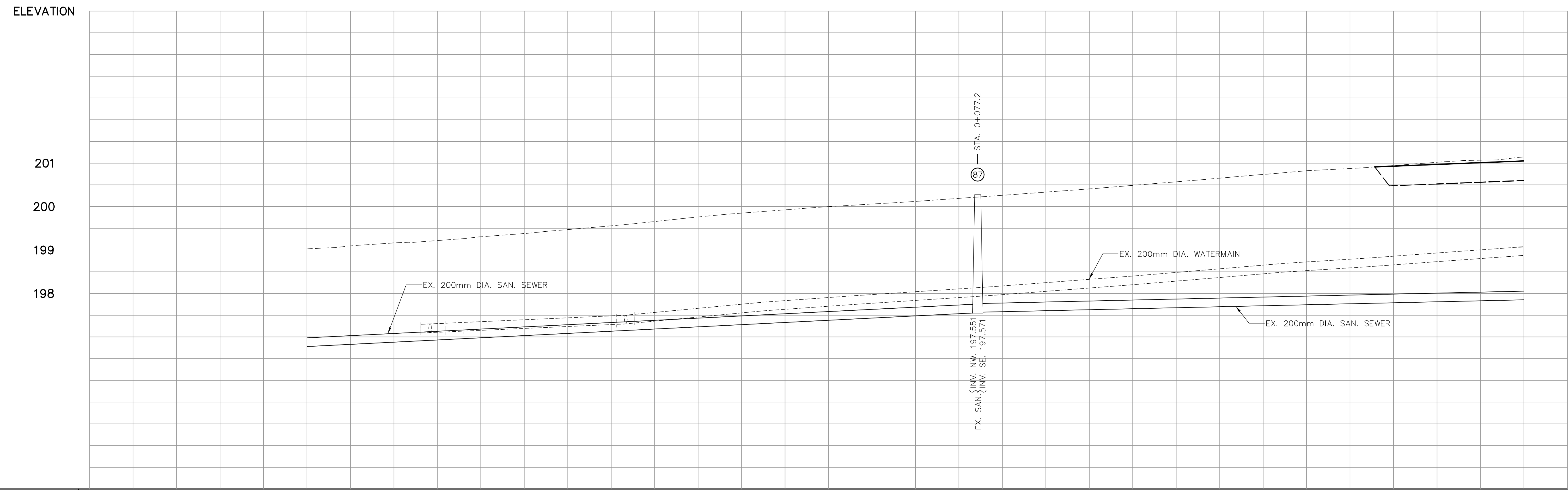

FINISHED ASPHALT GRADE	EXISTING Q GRADE	STATION	STATION	EXISTING Q GRADE	FINISHED ASPHALT GRADE
	199.024	0+000	0+010	199.164	
	199.304	0+020	0+030	199.470	
	199.655	0+040	0+050	199.849	
	199.998	0+060	0+070	200.118	
	200.259	0+080	0+090	200.406	
	200.569	0+100	0+110	200.739	
	200.876	0+120	0+130	201.019	
	201.142	0+140			

**NOTES:**  
 1. WATERMAIN TO HAVE A MINIMUM SEPARATION FROM SEWERS OF 2.5m HORIZONTAL OR 0.5m VERTICAL. WHERE PROPER SEPARATION FROM SEWERS CAN NOT BE ACHIEVED, WATERMANS ARE TO BE CONCRETE ENCASED, AS DIRECTED.  
 2. RECONNECT EXISTING WATER, SANITARY AND STORM SERVICES, AS REQUIRED, EXACT LOCATION OF SERVICES TO BE DETERMINED AT TIME OF CONSTRUCTION.

**LEGEND**

— SAN. or STM.	EXISTING SEWERS, SANITARY or STORM
— M.H. CB.	MANHOLE and CATCHBASIN
— W.	WATERMAIN
—	GASMAIN
—	UNDERGROUND TELEPHONE
—	UNDERGROUND HYDRO
—	UNDERGROUND T.V. CABLE
—	UTILITY POLES
—	GRUBBING
—	REMOVE EXISTING CONC. SIDEWALK AND DRIVES
—	REMOVE AND PLACE CONC. SIDEWALK AND DRIVES
—	PLACE CONC. SIDEWALK AND DRIVES
—	REMOVE EXISTING ASPHALT PAVT
—	PLACE HOT MIX ASPHALT (DRIVES 50mm HCL HOT MIX MBSCL)
—	REMOVE EXISTING CONC. CURB

**NOTE**  
 The locations of existing underground utilities are shown in an approximate way only and have not been independently verified by the owner or its representative. The contractor shall determine the exact location of all existing utilities before commencing work and agrees to be fully responsible for any damages which might be occasioned by the contractor's failure to exactly locate and preserve any and all underground utilities.

**BENCHMARK INFORMATION**  
 BM Elev. 201.719  
 Nail and Flag in West face of HLP at NE. corner of Main Street and Catherine Street  
 7.9m Lt of Sta. 0+144.4

**BENCHMARK INFORMATION**

Design By: JY Checked By: DLA

No.	DATE	REVISION
1	April 20, 2015	Council Presentation
2	May 27, 2015	Issued for MOE Approval
3	Oct. 19, 2016	Public Open House



Goderich (519) 524-2641 Mount Forest (519) 323-2945



**Municipality of Bluewater**  
**Main Street**  
**Road Reconstruction**  
**Plan and Profile**  
**From Sta. 0+140 to Sta. 0+300**

<b>Project No.</b> 14106
<b>Drawing No.</b> 2

Scale  
 Horizontal : 1:250  
 Vertical : 1:50

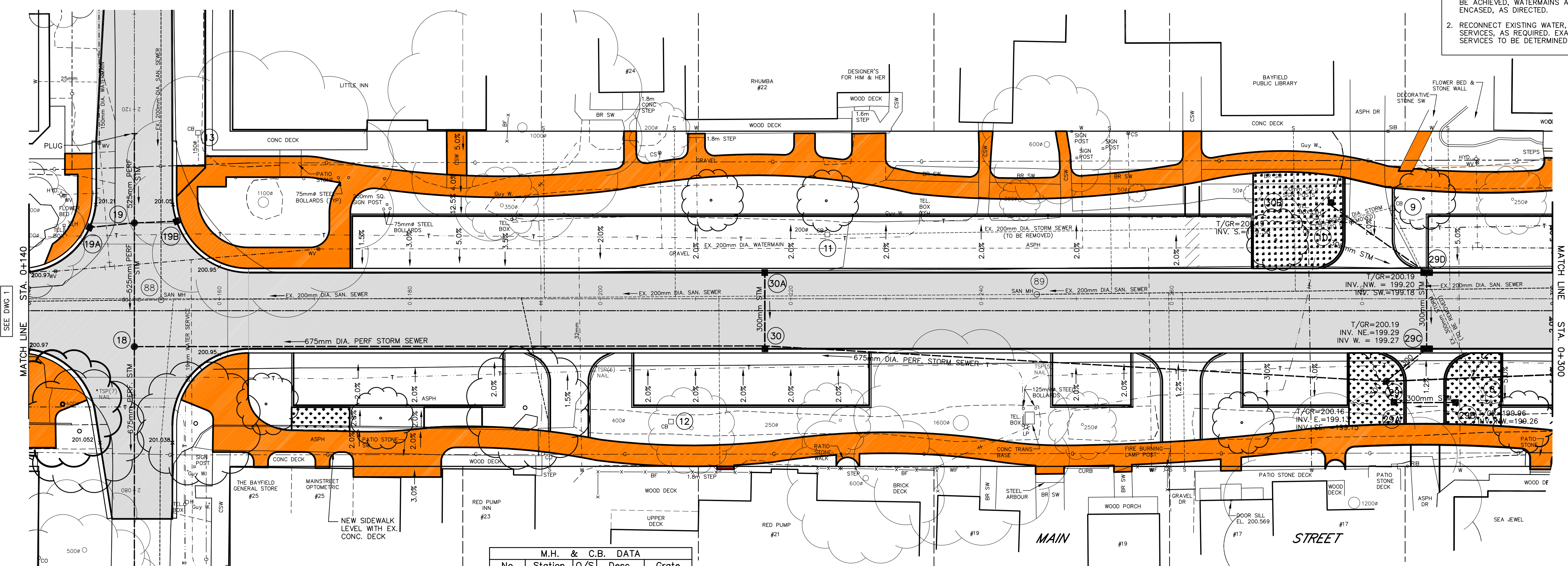

**SEWER DATA**

No to No	Size	Type	Class	Length
29B-29A	300	HDPE	BOSS 2000 PERF	11.4
29A-29	300	HDPE	BOSS 2000 PERF	2.8
30B-29D	300	HDPE	BOSS 2000 PERF	15.9
29D-29C	300	HDPE	BOSS 2000 PERF	8.0
29C-29	300	HDPE	BOSS 2000 PERF	5.4
29-30	675	HDPE	BOSS 2000 PERF	65.4
30A-30	300	HDPE	BOSS 2000 PERF	8.0
30-18	675	HDPE	BOSS 2000 PERF	66.2
STUB-19	525	HDPE	BOSS 2000 PERF	9.4
19A-19	300	HDPE	BOSS 2000 PERF	4.9
19B-19	300	HDPE	BOSS 2000 PERF	4.6
19-18	525	HDPE	BOSS 2000 PERF	13.0

**M.H. & C.B. DATA**

No	Station	O/S	Desc.	Grate
8	0+292	RT	REMOVE	
9	0+283	LT	REMOVE	
10	0+274	LT	REMOVE	
11	0+223	LT	REMOVE	
12	0+208	RT	REMOVE	
13	0+157	LT	REMOVE	
18	0+151	RT	STM,CEPTOR	401.010B (B)
19A	0+146	LT	705.010	400.110 (S)
19B	0+155	LT	705.010	400.110 (S)
19	0+151	LT	701.010	401.010B (B)
29A	0+281	RT	705.010	400.110 (S)
29B	0+292	RT	705.010	400.110 (S)
29C	0+287	RT	705.020	400.110(2) (S)
29D	0+287	LT	705.020	400.110(2) (S)
29	0+282	RT	701.012	401.010A (B)
30A	0+218	LT	705.010	400.110 (S)
30B	0+272	LT	705.010	400.110 (S)
30	0+218	RT	701.011	400.110 (B)

**SANITARY M.H. DATA**

No	Station	O/S	Desc.	Grate
88	0+154	LT	ADJUST	
89	0+246	LT	REBUILD	

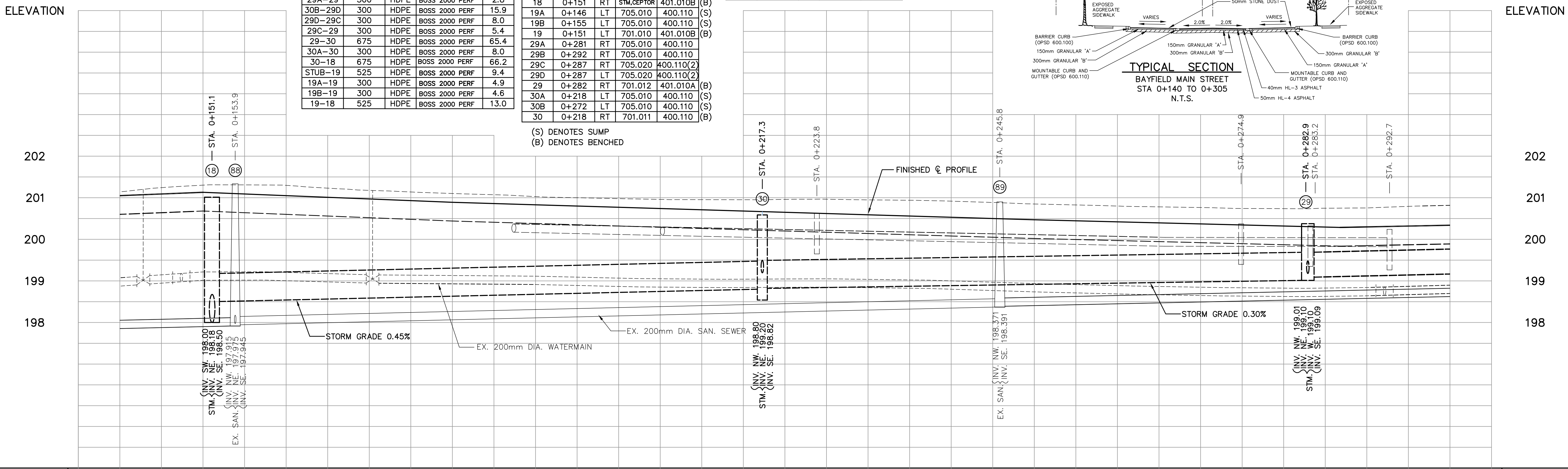
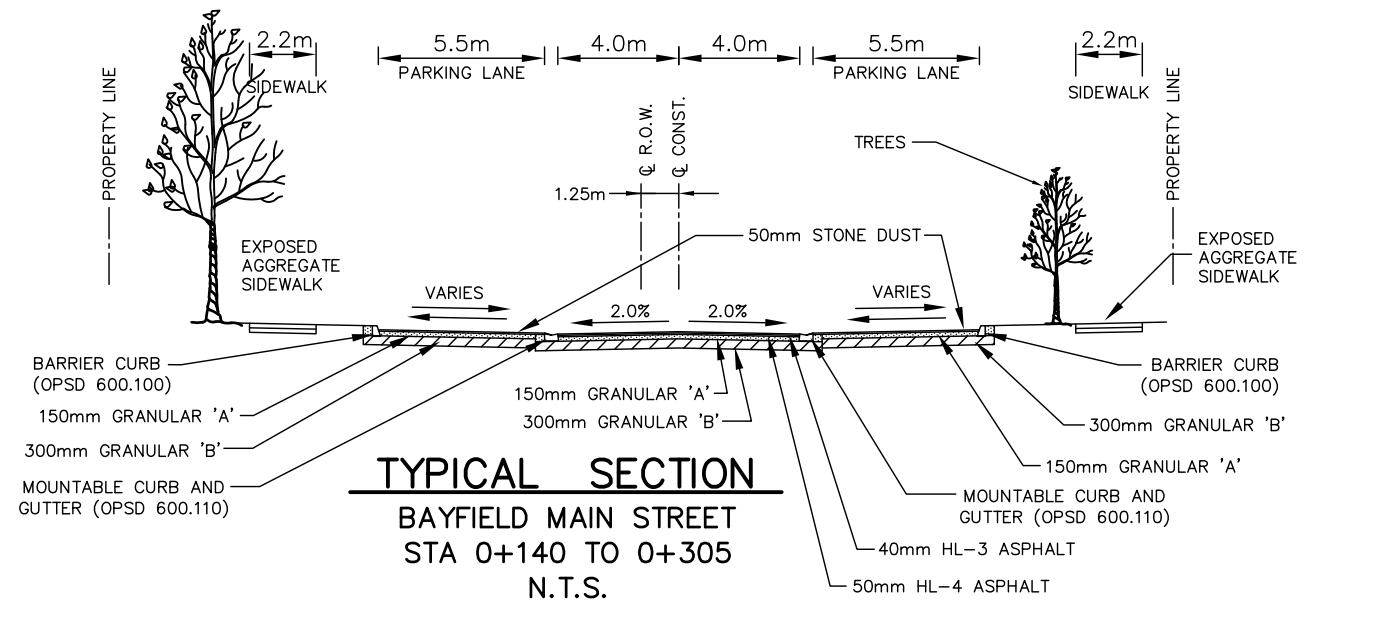

FINISHED ASPHALT GRADE	201.05	201.13	201.04	200.94	200.85	200.75	200.70	200.65	200.60	200.55	200.50	200.45	200.40	200.35	200.30	200.28	200.32	FINISHED ASPHALT GRADE
EXISTING C. GRADE	201.142	201.302	201.298	201.177	201.102	201.027	200.979	200.954	200.959	200.948	200.917	200.849	200.800	200.765	200.737	200.754	200.817	EXISTING C. GRADE
STATION	0+140	0+150	0+160	0+170	0+180	0+190	0+200	0+210	0+220	0+230	0+240	0+250	0+260	0+270	0+280	0+290	0+300	STATION

- NOTES:**
1. WATERMAIN TO HAVE A MINIMUM SEPARATION FROM SEWERS OF 2.5m HORIZONTAL OR 0.5m VERTICAL. WHERE PROPER SEPARATION FROM SEWERS CAN NOT BE ACHIEVED, WATERMANS ARE TO BE CONCRETE ENCASED, AS DIRECTED.
  2. RECONNECT EXISTING WATER, SANITARY AND STORM SERVICES, AS REQUIRED. EXACT LOCATION OF SERVICES TO BE DETERMINED AT TIME OF CONSTRUCTION.

**LEGEND**

— SAN. or STM.	EXISTING SEWERS, SANITARY or STORM
— M.H. or C.B.	MANHOLE and CATCHBASIN
— W	WATERMAIN
—	GASMAIN
— T	UNDERGROUND TELEPHONE
—	UNDERGROUND HYDRO
— TV	UNDERGROUND T.V. CABLE
H B T U H-B LP X	UTILITY POLES
—	GRUBBING
—	REMOVE EXISTING CONC. SIDEWALK AND DRIVES
—	REMOVE AND PLACE CONC. SIDEWALK AND DRIVES
—	PLACE CONC. SIDEWALK AND DRIVES
—	REMOVE EXISTING ASPHALT PAVT
—	PLACE HOT MIX ASPHALT DRIVES (30% H.C. HOT MIX MBSCL)
—	REMOVE EXISTING CONC. CURB

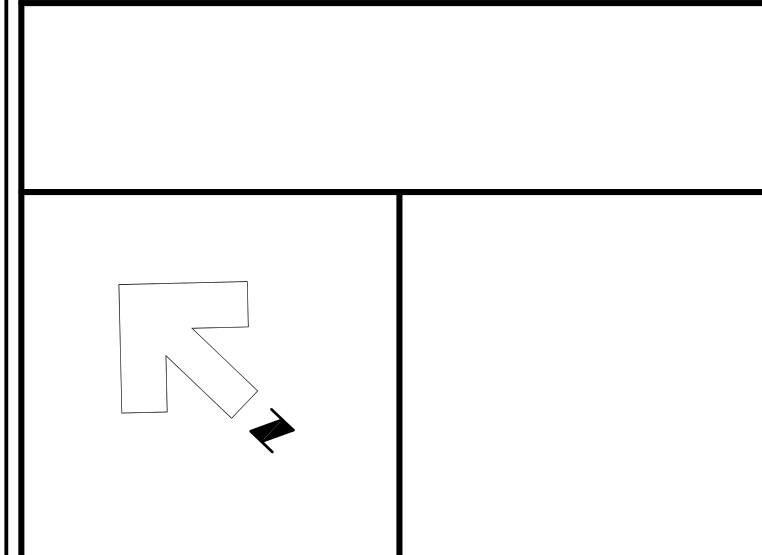

**NOTE**

The locations of existing underground utilities are shown in an approximate way only and have not been independently verified by the owner or its representative. The contractor shall determine the exact location of all existing utilities before commencing work and agrees to be fully responsible for any damages which might be occasioned by the contractor's failure to exactly locate and preserve any and all underground utilities.

**BENCHMARK INFORMATION**

BM Elev. 201.420  
Nail and Flag in West face of HLP at NE. corner of Main Street and Charles Street  
9.7m Lt of Sta. 0+358.2

**BENCHMARK INFORMATION**

BM Elev. 201.455  
Nail and Flag in West face of HLP on E side of Main Street, South of Charles Street  
9.9m Lt of Sta. 0+447.7

Design By: JY Checked By: DLA

No.	DATE	REVISION
1	April 20, 2015	Council Presentation
2	May 27, 2015	Issued for MOE Approval
3	Oct. 19, 2016	Public Open House



Goderich (519) 524-2641 Mount Forest (519) 323-2945



**Municipality of Bluewater**  
**Main Street**  
Road Reconstruction  
Plan and Profile  
From Sta. 0+300 to Sta. 0+460

<b>Project No.</b> 14106
<b>Drawing No.</b> 3

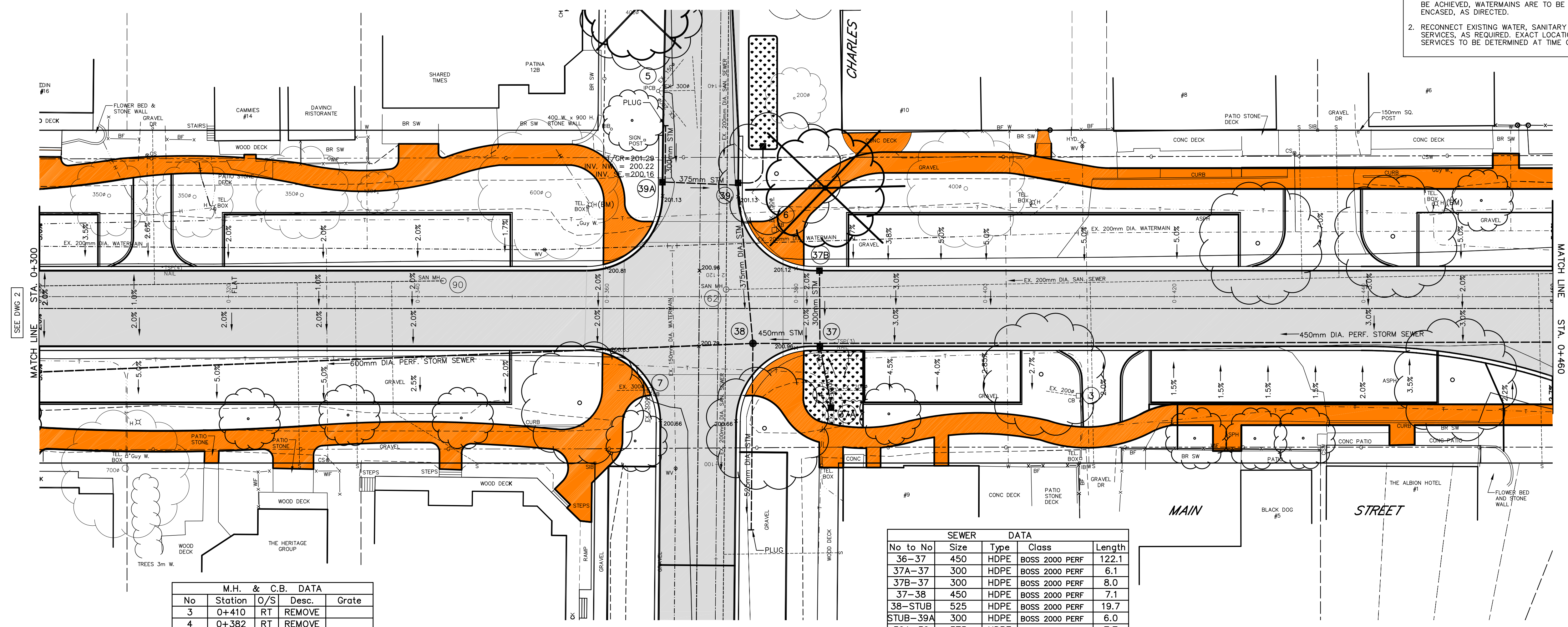

**M.H. & C.B. DATA**

No	Station	O/S	Desc.	Grate
3	0+410	RT	REMOVE	
4	0+382	RT	REMOVE	
5	0+365	LT	REMOVE	
6	0+377	LT	REMOVE	
7	0+364	RT	REMOVE	
37A	0+385	RT	705.010	400.110
37B	0+382	LT	705.010	400.110
37	0+382	RT	701.010	400.110 (S)
38	0+375	RT	STM.CEPTOR	401.010B (B)
39A	0+366	LT	701.010	400.110 (S)
39	0+374	LT	701.010	400.110 (S)

**SANITARY M.H. DATA**

No	Station	O/S	Desc.	Grate
90	0+343	LT	REBUILD	
62	0+373	LT	REBUILD	

**SEWER DATA**

No to No	Size	Type	Class	Length
36-37	450	HDPE	BOSS 2000 PERF	122.1
37A-37	300	HDPE	BOSS 2000 PERF	6.1
37B-37	300	HDPE	BOSS 2000 PERF	8.0
37-38	450	HDPE	BOSS 2000 PERF	7.1
38-STUB	525	HDPE	BOSS 2000 PERF	19.7
STUB-39A	300	HDPE	BOSS 2000 PERF	6.0
39A-39	375	HDPE	BOSS 2000 PERF	7.7
39-38	375	HDPE	BOSS 2000 PERF	16.8
38-29	600	HDPE	BOSS 2000 PERF	93.0

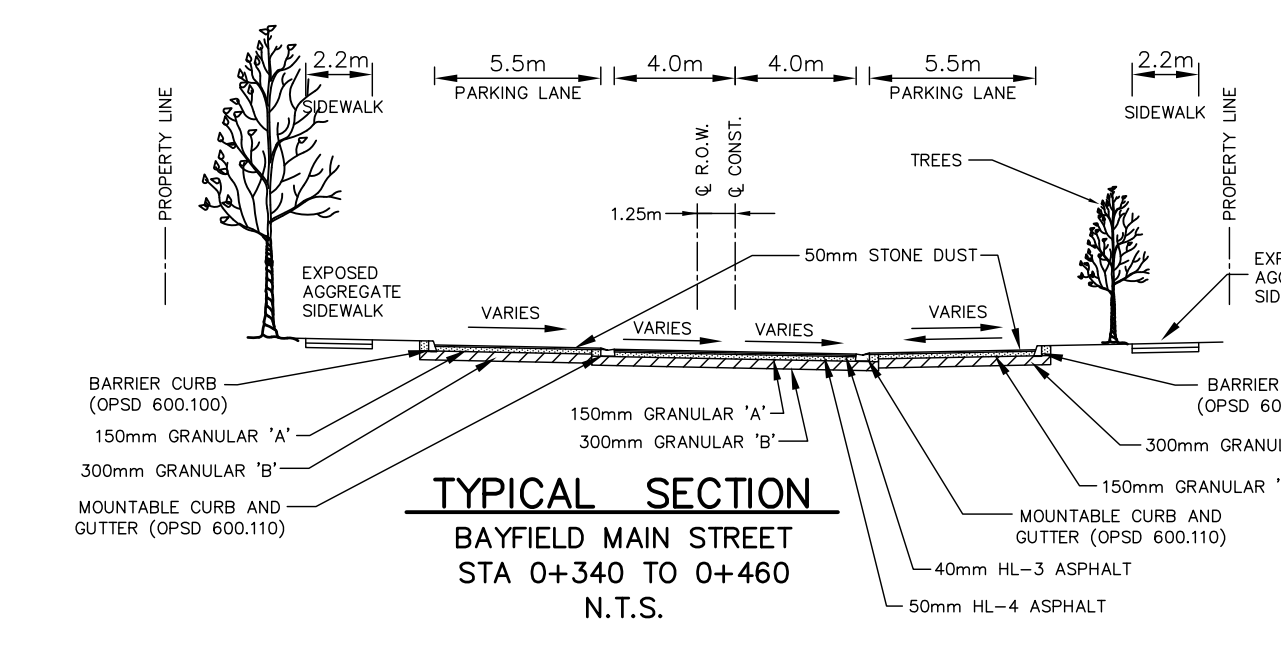
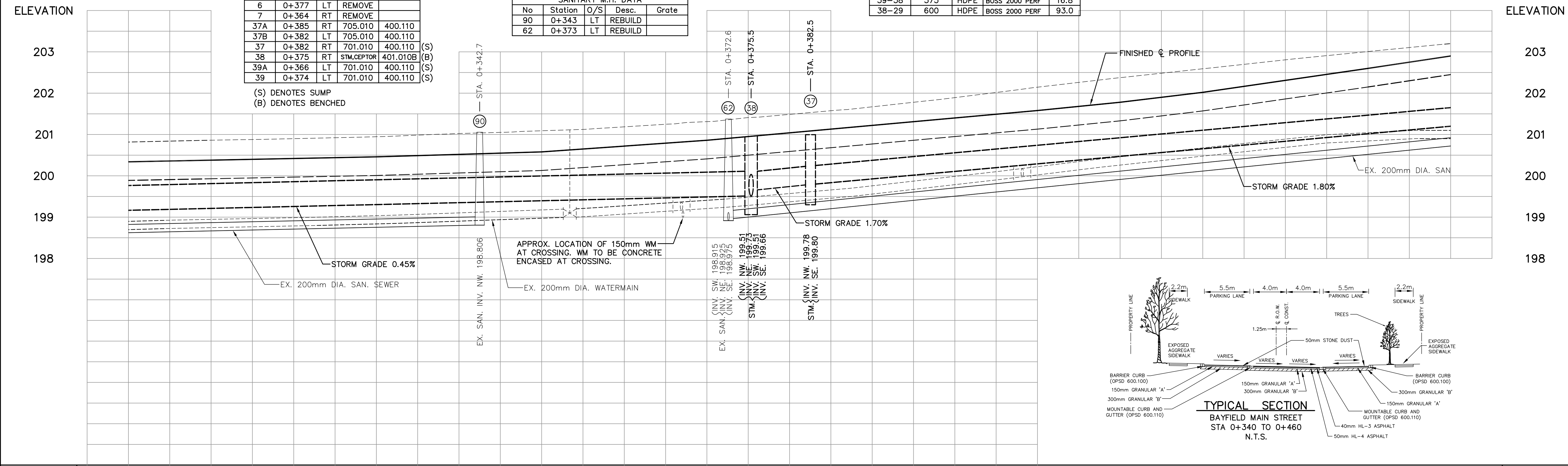

FINISHED ASPHALT GRADE	200.32	200.36	200.40	200.44	200.48	200.52	200.70	200.88	201.06	201.24	201.42	201.60	201.78	201.96	202.26	202.56	202.86	FINISHED ASPHALT GRADE
EXISTING C GRADE	200.817	200.862	200.899	200.946	201.024	201.090	201.186	201.311	201.486	201.670	201.892	202.145	202.376	202.590	202.807	203.008	203.199	EXISTING C GRADE
STATION	0+300	0+310	0+320	0+330	0+340	0+350	0+360	0+370	0+380	0+390	0+400	0+410	0+420	0+430	0+440	0+450	0+460	STATION

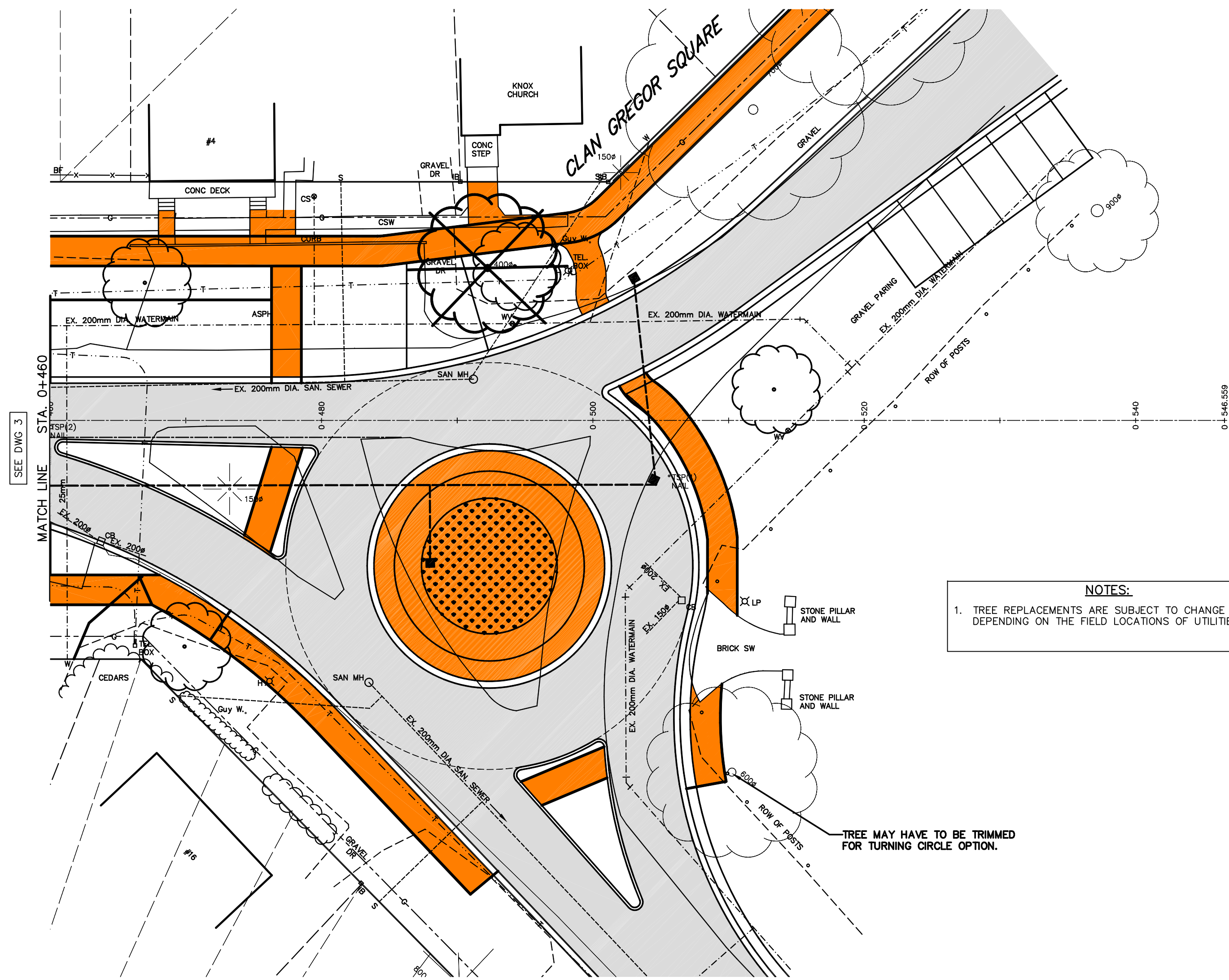

**NOTES:**  
 1. TREE REPLACEMENTS ARE SUBJECT TO CHANGE DEPENDING ON THE FIELD LOCATIONS OF UTILITIES.  
 2. TREE MAY HAVE TO BE TRIMMED FOR TURNING CIRCLE OPTION.

**NOTES:**  
 1. WATERMAIN TO HAVE A MINIMUM SEPARATION FROM SEWERS OF 2.5m HORIZONTAL OR 0.5m VERTICAL. WHERE PROPER SEPARATION FROM SEWERS CAN NOT BE ACHIEVED, WATERMANS ARE TO BE CONCRETE ENCASED, AS DIRECTED.  
 2. RECONNECT EXISTING WATER, SANITARY AND STORM SERVICES, AS REQUIRED. EXACT LOCATION OF SERVICES TO BE DETERMINED AT TIME OF CONSTRUCTION.

**LEGEND**

SAN. or STM.	EXISTING SEWERS, SANITARY or STORM
M, CB	MANHOLE and CATCHBASIN
W	WATERMAIN
+	FIRE HYDRANT
—	GASMAIN
—	UNDERGROUND TELEPHONE
—	UNDERGROUND HYDRO
—	UNDERGROUND T.V. CABLE
H, B, T, H-B, LP	UTILITY POLES
⊗	GRUBBING
▨	REMOVE EXISTING CONC. SIDEWALK AND DRIVES
▧	REMOVE AND PLACE CONC. SIDEWALK AND DRIVES
▩	PLACE CONC. SIDEWALK AND DRIVES
▪	REMOVE EXISTING ASPHALT PAVT
▫	PLACE HOT MIX ASPHALT DRIVES (50mm H.C. HOT MIX MISC.)
▬	REMOVE EXISTING CONC. CURB

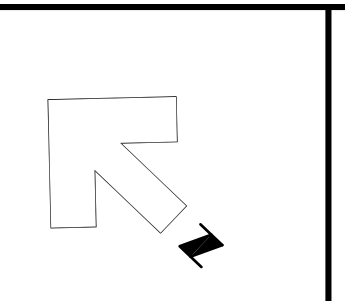

**NOTE**  
 The locations of existing underground utilities are shown in an approximate way only and have not been independently verified by the owner or its representative. The contractor shall determine the exact location of all existing utilities before commencing work and agrees to be fully responsible for any damages which might be occasioned by the contractor's failure to exactly locate and preserve any and all underground utilities.

**BENCHMARK INFORMATION**  
 ?  
 ?  
 ?

**BENCHMARK INFORMATION**  
 ?  
 ?  
 ?

Design By: JY      Checked By: DLA

**PRELIMINARY**

No.	DATE	REVISION
1	April 20, 2015	Council Presentation
2	Oct. 19, 2016	Public Open House



Goderich (519) 524-2641      Mount Forest (519) 323-2945



**Municipality of Bluewater**  
**Main Street**  
**Road Reconstruction**  
**Plan and Profile**  
**From Sta. 0+460 to Sta. 0+520**

<b>Project No.</b> 14106
<b>Drawing No.</b> 4

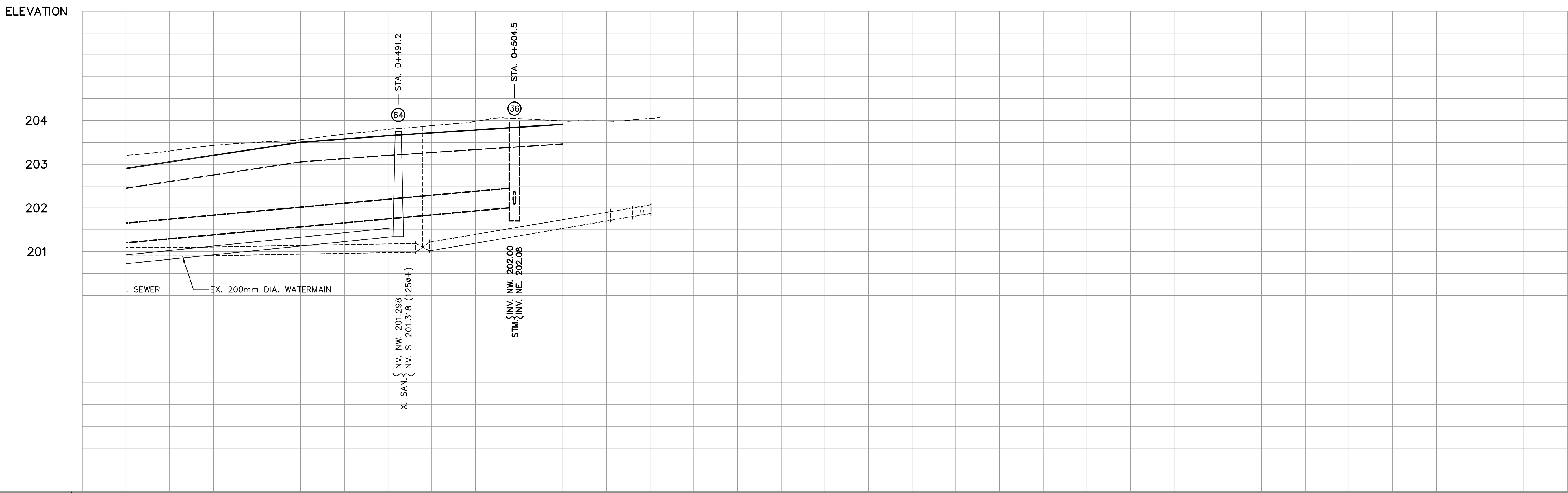

FINISHED ASPHALT GRADE	202.90	203.50	203.65	203.78	203.987	204.045
EXISTING G. GRADE	203.199	203.425	203.556	203.798	203.976	204.045
STATION	0+460	0+470	0+480	0+490	0+500	0+520

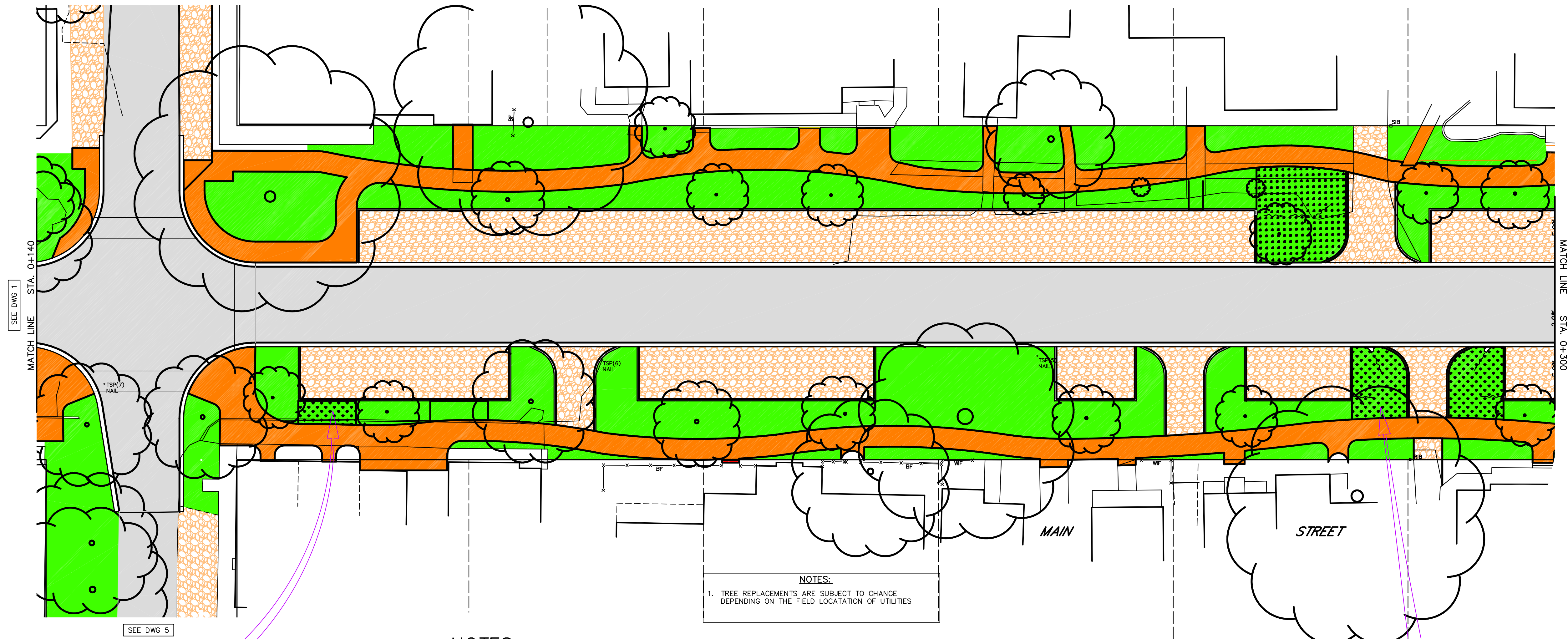

**NOTES:**  
 1. TREE REPLACEMENTS ARE SUBJECT TO CHANGE DEPENDING ON THE FIELD LOCATATION OF UTILITIES

- NOTES:**
- 1) Prune plants a min. amount to remove dead or injured members. Maintain natural character and shape of the species. Do not cut the leader branch.
  - 2) Paint all cuts to branches with approved tree paint.

**TREE HEALTH REPORT - BOULEVARD TREES**

LARGE TREES NATIVE TO NORTH AMERICA
NYSSA SYLVATICA BLACK GUM
MAGNOLIA ACUMINATE CUCUMBERTREE
LINODENDRON TULIPTREE
CATALPA SPECIOSA NORTHERN CATALPA (PARKS ONLY)
CLADASTRIS KENTUCKEA YELLOW-WOOD
GYMNOCLADUS DIOICUS KENTUCKY COFFEE TREE
GLEDITSIA TRICANTHOS INTERMIS 'SKYLINE' SKYLINE HONEY-LOCUST
SYRINGA RETICULATA 'IVORY SILK' LILAC ZONE 4

LARGE TREES FOR BOULEVARDS
ACER SACHARUM SUGAR MAPLE
ACER SACCHARINE SILVER MAPLE
ACER RUBRUM RED MAPLE - PARKS ONLY
FAGUS BEECH
QUERCUS RUBRA RED OAK
QUERCUS MACROCARPA BUR OAK
QUERCUS ALBA WHITE OAK
QUERCUS MUEHLENBERGII CHINQUAPIN OAK
CELTIS OCCIDENTALIS HACKBERRY

NATIVE TO EUROPE/ASIA AND HYBRIDS
QUERCUS ROBUR ENGLISH OAK
GINKGO BILOBA MAINDENHAIR TREE
AESCULUS HIPPOCASTANUM HORSE-CHESTNUT
CORYLUS COLURNA TURKISH HAZEL
PHELLLODENDRON AMURENSE AMUR CORK
TILLIA CORDATE LITTLE LEAF LINDEN
FAGUS SYLVATICA EUROPEAN BEECH
AESCULUS CARNEA BRIOTI RUBY RED HORSE-CHESTNUT
TILLIA AMERICANA 'REDMOND' REDMOND LINDEN
ACER RUBRUM 'AUTUMN FLAME'
ACER X FREMANII FREEMAN MAPLE
ACER RUBRUM 'AUTUMN FLAME'

BOULEVARD TREES SUITABLE FOR UNDER HYDRO WIRES
ACER GRISEUM PAPERBARK MAPLE
ACER GINNALA 'FLAME' AMUR MAPLE ZONE 2
ACER TATARICUM TATARIAN MAPLE ZONE 3
ASIMINA TRILOBA COMMON PAWPAW ZONE 5
MALUS CRAB APPLE ZONE 4
PRUNUS SERRULATA ZONE 5
PYRUS ORNAMENTAL PEAR
SYRINGA RETICULATA 'IVORY SILK' LILAC ZONE 4
QUERCUS ROBUR 'FASTIGITA'

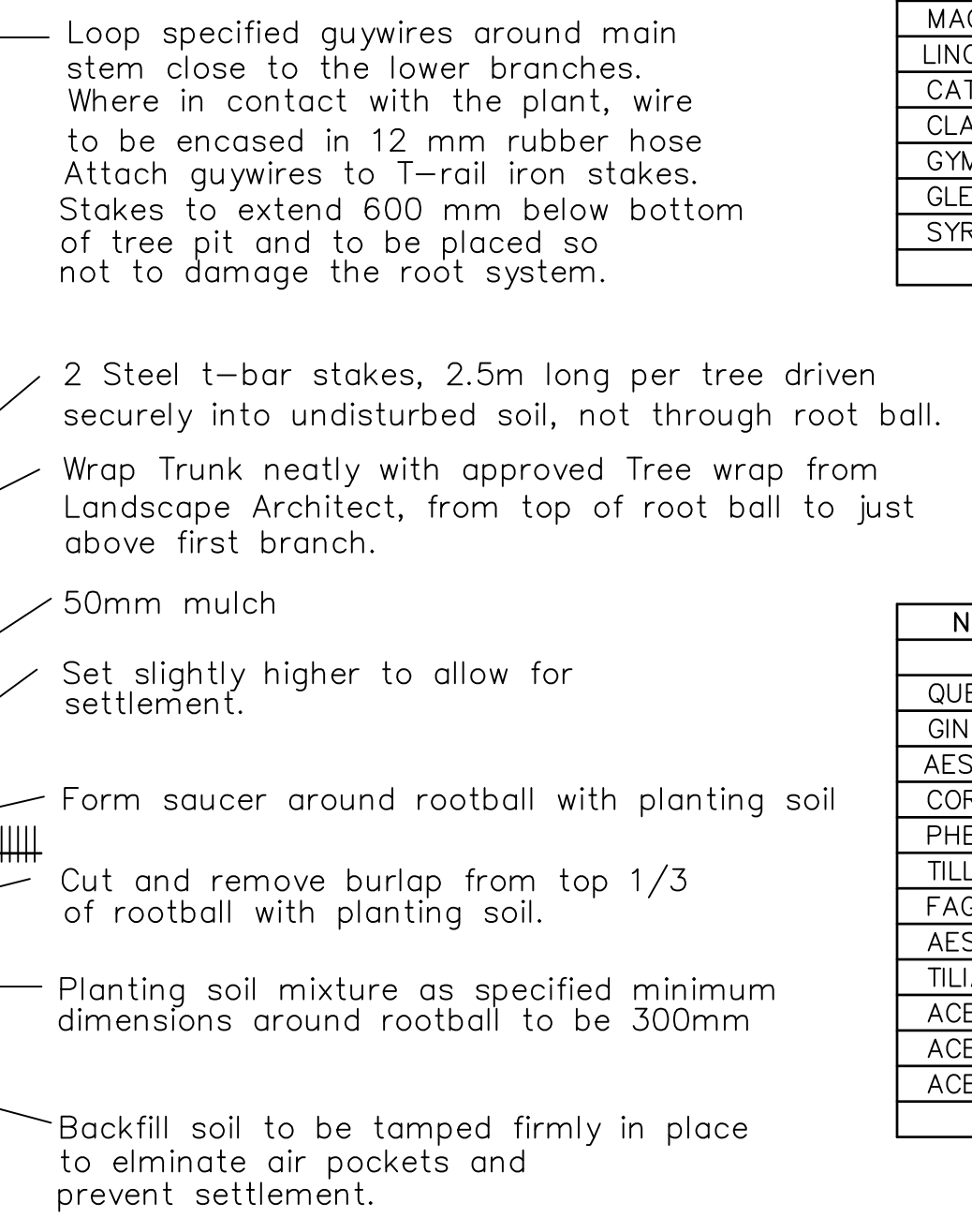

**DECIDUOUS TREE PLANTING**



**BIORETENTION PLANTER**



**BIORETENTION CURB EXTENSION**

**LEGEND**

- SAN. or STM. EXISTING SEWERS, SANITARY or STORM
- MANHOLE and CATCHBASIN
- WATERMAIN
- GASMAIN
- UNDERGROUND TELEPHONE
- UNDERGROUND HYDRO
- UNDERGROUND T.V. CABLE
- UTILITY POLES
- GRUBING
- EXPOSED AGGREGATE SIDEWALK
- GREENSPACE
- GRAVEL SURFACE
- HOT MIX ASPHALT
- BIORETENTION OPPORTUNITIES

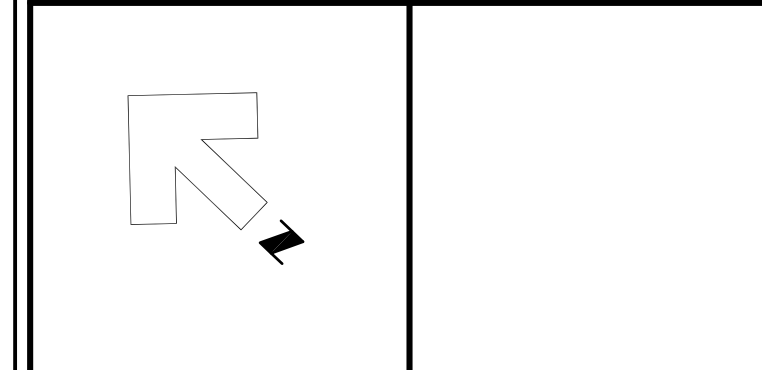
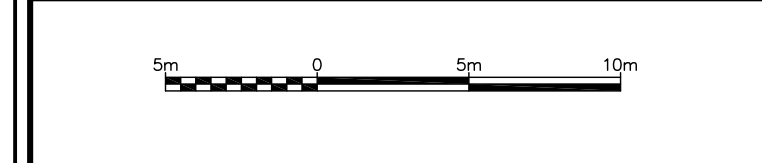

**NOTE**  
 The locations of existing underground utilities are shown in an approximate way only and have not been independently verified by the owner or its representative. The contractor shall determine the exact location of all existing utilities before commencing work and agrees to be fully responsible for any damages which might be occasioned by the contractor's failure to exactly locate and preserve any and all underground utilities.

**BENCHMARK INFORMATION**  
 BM Elev. 201.719  
 Nail and Flag in West face of HLP at NE. corner of Main Street and Catherine Street  
 7.9m Lt of Sta. 0+144.4

**BENCHMARK INFORMATION**

Design By: JY      Checked By: DLA

No.	DATE	REVISION
1	April 20, 2015	Council Presentation
2	Aug. 15, 2015	Stakeholder Presentation
3	Oct. 19, 2016	Public Open House



Goderich (519) 624-2641      Mount Forest (519) 333-2945



**Municipality of Bluewater**  
**Main Street Landscaping**  
 From Sta. 0+140 to Sta. 0+300

Project No. 14106  
 Drawing No. 6  
 Scale: Horizontal: 1:250, Vertical: 1:50

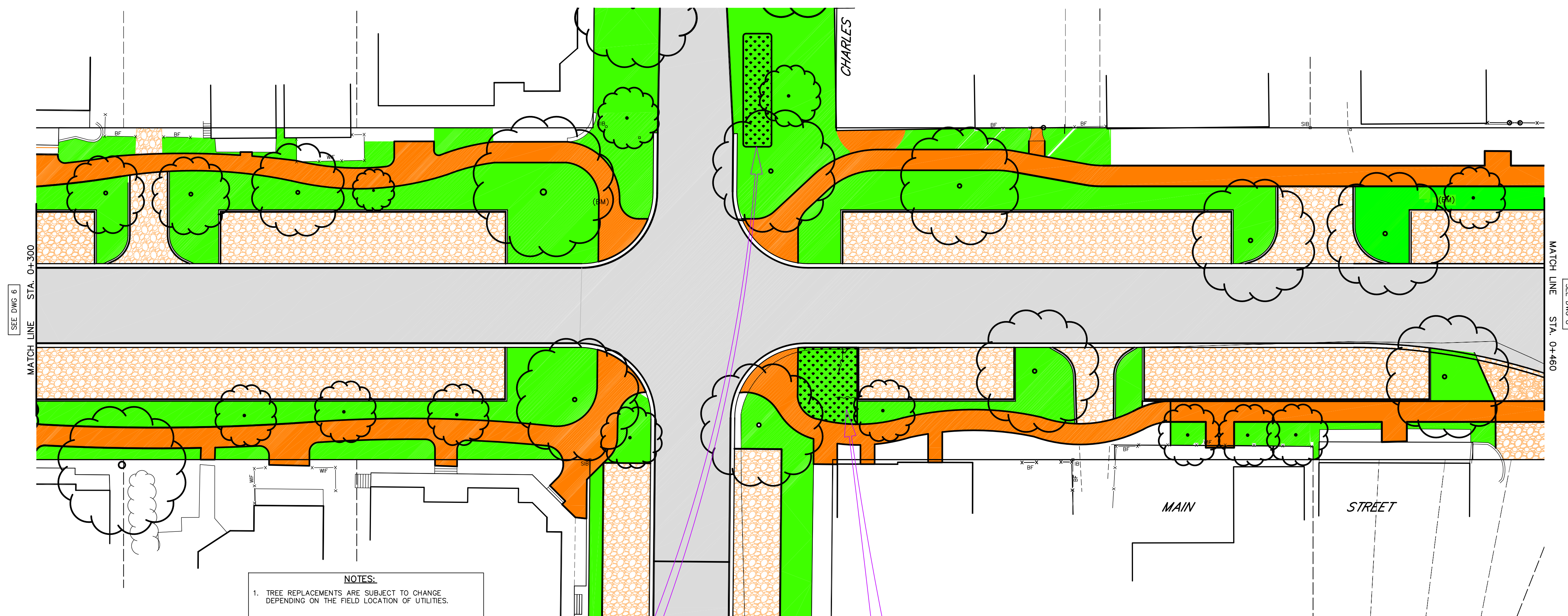

**NOTES:**  
1. TREE REPLACEMENTS ARE SUBJECT TO CHANGE DEPENDING ON THE FIELD LOCATION OF UTILITIES.

**NOTES:**  
1) Prune plants a min. amount to remove dead or injured members. Maintain natural character and shape of the species. Do not cut the leader branch.  
2) Paint all cuts to branches with approved tree paint.

**TREE HEALTH REPORT - BOULEVARD TREES**

LARGE TREES NATIVE TO NORTH AMERICA
NYSSA SYLVATICA BLACK GUM
MAGNOLIA ACUMINATA CUCUMBERTREE
LINODENDRON TULIPTREE
CATALPA SPECIOSA NORTHERN CATALPA (PARKS ONLY)
CLADASTRIS KENTUCKEA YELLOW-WOOD
GYMNOCLADUS DIOICIS KENTUCKY COFFEE TREE
GLEDITSIA TRICANTHOS 'INTERMIS' 'SKYLINE' SKYLINE HONEY-LOCUST
SYRINGA RETICULATA 'IVORY SILK' LILAC ZONE 4

LARGE TREES FOR BOULEVARDS
ACER SACHARUM SUGAR MAPLE
ACER SACCHARINE SILVER MAPLE
ACER RUBRUM RED MAPLE - PARKS ONLY
FAGUS BEECH
QUERCUS RUBRA RED OAK
QUERCUS MACROCARPA BUR OAK
QUERCUS ALBA WHITE OAK
QUERCUS MUEHLENBERGII CHINQUAPIN OAK
CELTIS OCCIDENTALIS HACKBERRY

NATIVE TO EUROPE/ASIA AND HYBRIDS
QUERCUS ROBUR ENGLISH OAK
GINKGO BILOBA MAINDENHAIR TREE
AESCULUS HIPPOCASTANUM HORSE-CHESTNUT
CORYLUS COLURNA TURKISH HAZEL
PHILODENDRON AMURENSE AMUR CORK
TILLIA CORDATE LITTLE LEAF LINDEN
FAGUS SYLVATICA EUROPEAN BEECH
AESCULUS CARNEA BROTTI RUBY RED HORSE-CHESTNUT
TILIA AMERICANA 'REDMOND' REDMOND LINDEN
ACER RUBRUM 'AUTUMN FLAME'
ACER X FREMANII FREEMAN MAPLE
ACER RUBRUM 'AUTUMN FLAME'

BOULEVARD TREES SUITABLE FOR UNDER HYDRO WIRES
ACER GRISEUM PAPERBARK MAPLE
ACER GINNALA 'FLAME' AMUR MAPLE ZONE 2
ACER TATARICUM TATARIAN MAPLE ZONE 3
ASIMINA TRILOBA COMMON PAPAWE ZONE 5
MALUS CRAB APPLE ZONE 4
PRUNUS SERRULATA ZONE 5
PYRUS ORNAMENTAL PEAR
SYRINGA RETICULATA 'IVORY SILK' LILAC ZONE 4
QUERCUS ROBUR 'FASTIGIATA'



**BOULEVARD BIORETENTION UNIT**



**BIORETENTION CURB EXTENSION**

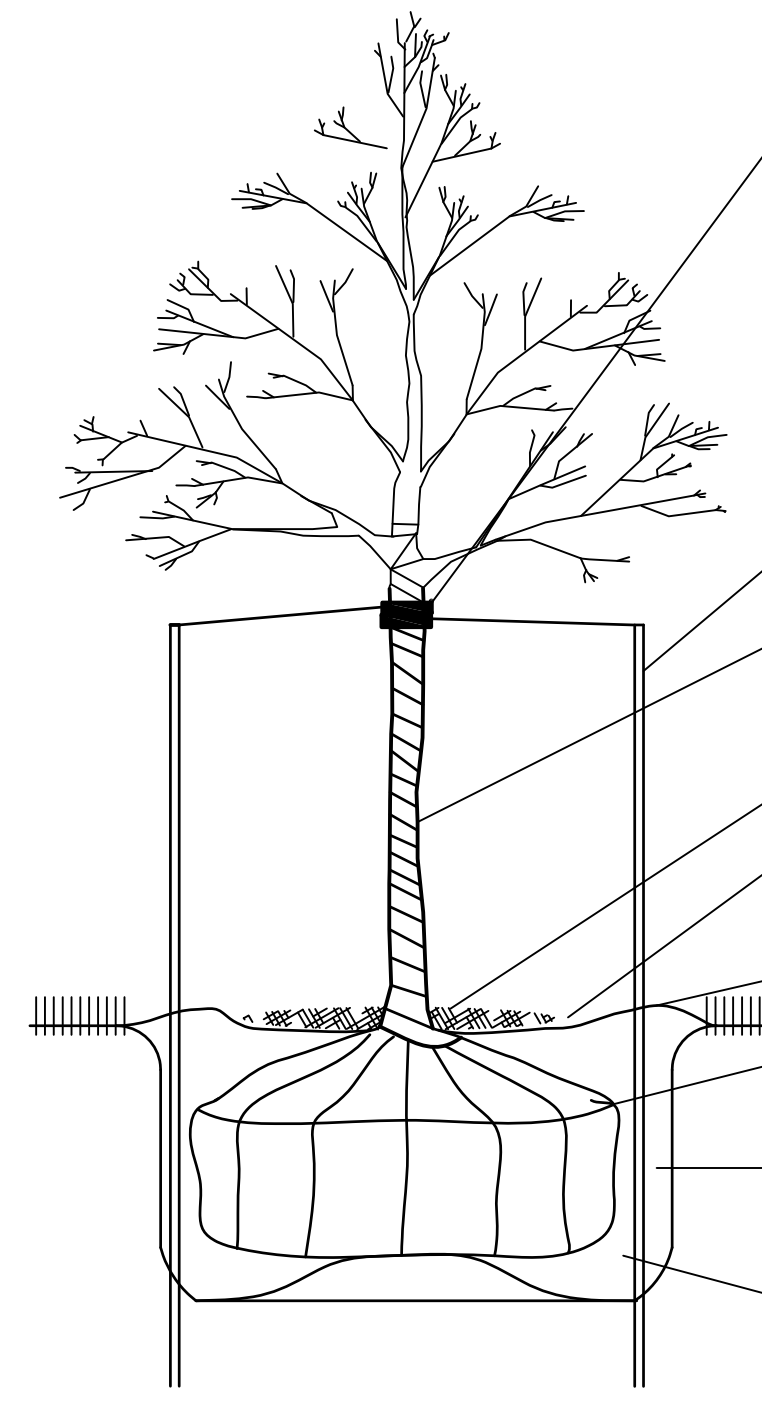

**DECIDUOUS TREE PLANTING**

Loop specified guywires around main stem close to the lower branches. Where in contact with the plant, wire to be encased in 12 mm rubber hose. Attach guywires to T-rail iron stakes. Stakes to extend 600 mm below bottom of tree pit and to be placed so not to damage the root system.

2 Steel t-bar stakes, 2.5m long per tree driven securely into undisturbed soil, not through root ball.

Wrap trunk neatly with approved Tree wrap from Landscape Architect, from top of root ball to just above first branch.

50mm mulch

Set slightly higher to allow for settlement.

Form saucer around rootball with planting soil

Cut and remove burlap from top 1/3 of rootball with planting soil.

Planting soil mixture as specified minimum dimensions around rootball to be 300mm

Backfill soil to be tamped firmly in place to eliminate air pockets and prevent settlement.

**LEGEND**

- SAN. or STM. EXISTING SEWERS, SANITARY or STORM
- M.H. C.B. MANHOLE and CATCHBASIN
- W WATERMAIN
- G GASMAIN
- T UNDERGROUND TELEPHONE
- H UNDERGROUND HYDRO
- TV UNDERGROUND T.V. CABLE
- H B T H-B LP UTILITY POLES
- GRUBING
- EXPOSED AGGREGATE SIDEWALK
- GREENSPACE
- GRAVEL SURFACE
- HOT MIX ASPHALT
- BIORETENTION OPPORTUNITIES

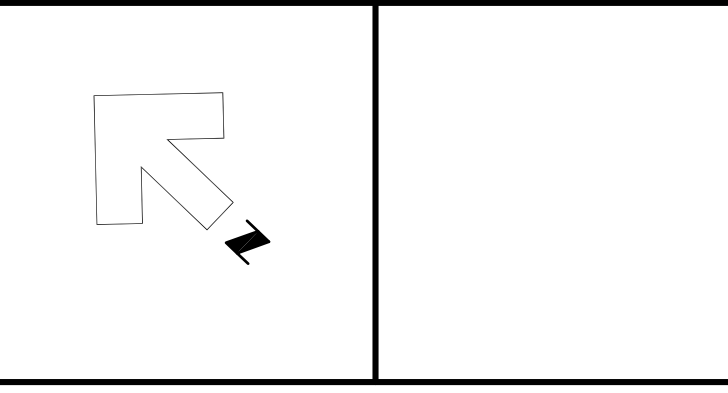
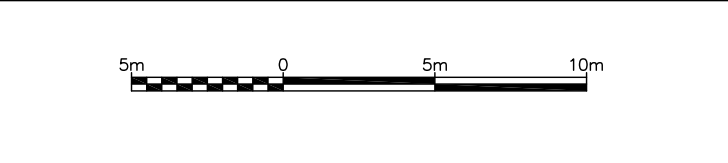

**NOTE**  
The locations of existing underground utilities are shown in an approximate way only and have not been independently verified by the owner or its representative. The contractor shall determine the exact location of all existing utilities before commencing work and agrees to be fully responsible for any damages which might be occasioned by the contractor's failure to exactly locate and preserve any and all underground utilities.

**BENCHMARK INFORMATION**  
BM Elev. 201.420  
Nail and Flag in West face of HLP at NE. corner of Main Street and Charles Street  
9.7m Lt of Sta. 0+358.2

**BENCHMARK INFORMATION**  
BM Elev. 201.455  
Nail and Flag in West face of HLP on E side of Main Street, South of Charles Street  
9.9m Lt of Sta. 0+447.7

Design By: JY Checked By: DLA

No.	DATE	REVISION
1	April 20, 2015	Council Presentation
2	Aug. 15, 2015	Stakeholder Presentation
3	Oct. 19, 2016	Public Open House



Goderich (519) 524-2641 Mount Forest (519) 333-2945



**Municipality of Bluewater**  
**Main Street Landscaping**

From Sta. 0+300 to Sta. 0+460

Project No. 14106

Scale Horizontal: 1:250  
Drawing No. 7

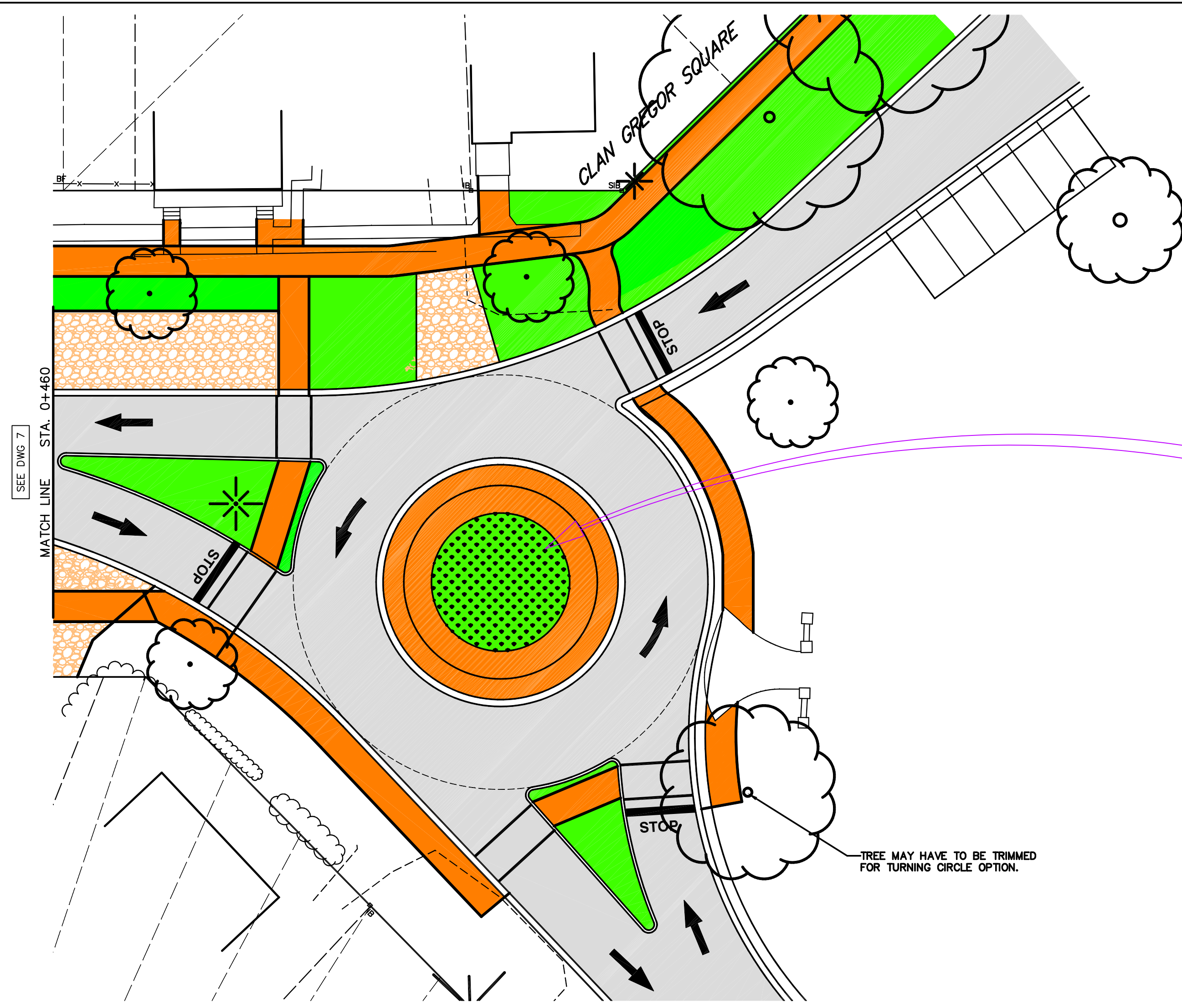

BIORETENTION PLANTER

**LEGEND**

San. or STM.	EXISTING SEWERS, SANITARY or STORM
M.H. CB	MANHOLE and CATCHBASIN
W	WATERMAIN
G	GASMAIN
T	UNDERGROUND TELEPHONE
H	UNDERGROUND HYDRO
TV	UNDERGROUND T.V. CABLE
H B T H-B LP	UTILITY POLES
GRUBING	GRUBING
EXP. AGGREGATE SIDEWALK	EXP. AGGREGATE SIDEWALK
GREENSPACE	GREENSPACE
GRAVEL SURFACE	GRAVEL SURFACE
HOT MIX ASPHALT	HOT MIX ASPHALT
BIORETENTION OPPORTUNITIES	BIORETENTION OPPORTUNITIES

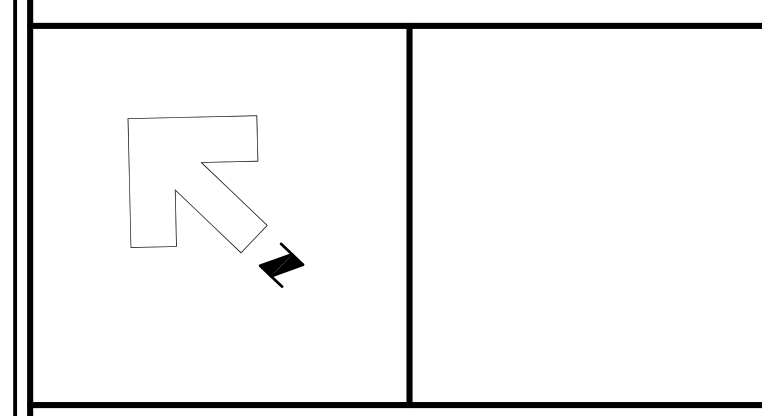

**NOTE**  
The locations of existing underground utilities are shown in an approximate way only and have not been independently verified by the owner or its representative. The contractor shall determine the exact location of all existing utilities before commencing work and agrees to be fully responsible for any damages which might be occasioned by the contractor's failure to exactly locate and preserve any and all underground utilities.

**BENCHMARK INFORMATION**  
?  
?  
?

**BENCHMARK INFORMATION**  
?  
?  
?

Design By: JY Checked By: DLA

**PRELIMINARY**

No.	DATE	REVISION
1	April 20, 2015	Council Presentation
2	Aug. 15, 2015	Stakeholder Presentation
3	Oct. 19, 2016	Public Open House



Goderich (519) 524-2641 Mount Forest (519) 323-2945



**Municipality of Bluewater**  
**Main Street Landscaping**  
From Sta. 0+460 to Sta. 0+520

**Project No.**  
14106

**Drawing No.**  
8

**TREE HEALTH REPORT - BOULEVARD TREES**

**LARGE TREES NATIVE TO NORTH AMERICA**

NYSSA SYLVATICA BLACK GUM
MAGNOLIA ACUMINATA CUCUMBERTREE
LINODENDRON TULIPTREE
CATALPA SPECIOSA NORTHERN CATALPA (PARKS ONLY)
CLADASTRIS KENTUCKEA YELLOW-WOOD
GYMNOCLADUS DIOICUS KENTUCKY COFFEE TREE
GLEDITSIA TRICANTHOS INTERMIS "SKYLINE" SKYLINE HONEY-LOCUST
SYRINGA RETICULATA "IVORY SILK" LILAC ZONE 4

**LARGE TREES FOR BOULEVARDS**

ACER SACHARUM SUGAR MAPLE
ACER SACCHARINE SILVER MAPLE
ACER RUBRUM RED MAPLE -- PARKS ONLY
FAGUS BEECH
QUERCUS RUBRA RED OAK
QUERCUS MACROCARPA BUR OAK
QUERCUS ALBA WHITE OAK
QUERCUS MUEHLENBERGII CHINQUAPIN OAK
CELTIS OCCIDENTALIS HACKBERRY

**NATIVE TO EUROPE/ASIA AND HYBRIDS**

QUERCUS ROBUR ENGLISH OAK
GINKGO BILOBA MAINDENHAIR TREE
AESCULUS HIPPOCASTANUM HORSE-CHESTNUT
CORYLUS COLURNA TURKISH HAZEL
PHELLODENDRON AMURENSE AMUR CORK
TILLIA CORDATE LITTLE LEAF LINDEN
FAGUS SYLVATICA EUROPEAN BEECH
AESCULUS CARNEA BRIOTI RUBY RED HORSE-CHESTNUT
TILLIA AMERICANA "REDMOND" REDMOND LINDEN
ACER RUBRUM "AUTUMN FLAME"
ACER X FREMANII FREEMAN MAPLE
ACER RUBRUM "AUTUMN FLAME"

**BOULEVARD TREES SUITABLE FOR UNDER HYDRO WIRES**

ACER GRISEUM PAPERBARK MAPLE
ACER GINNALA "FLAME" AMUR MAPLE ZONE 2
ACER TATARICUM TATARIAN MAPLE ZONE 3
ASIMINA TRILOBA COMMON PAWPAW ZONE 5
MALUS CRAB APPLE ZONE 4
PRUNUS SERRULATA ZONE 5
PYRUS ORNAMENTAL PEAR
SYRINGA RETICULATA "IVORY SILK" LILAC ZONE 4
QUERCUS ROBUR "FASTIGITA"

**NOTES:**

- 1) Prune plants a min. amount to remove dead or injured members. Maintain natural character and shape of the species. Do not cut the leader branch.
- 2) Paint all cuts to branches with approved tree paint.

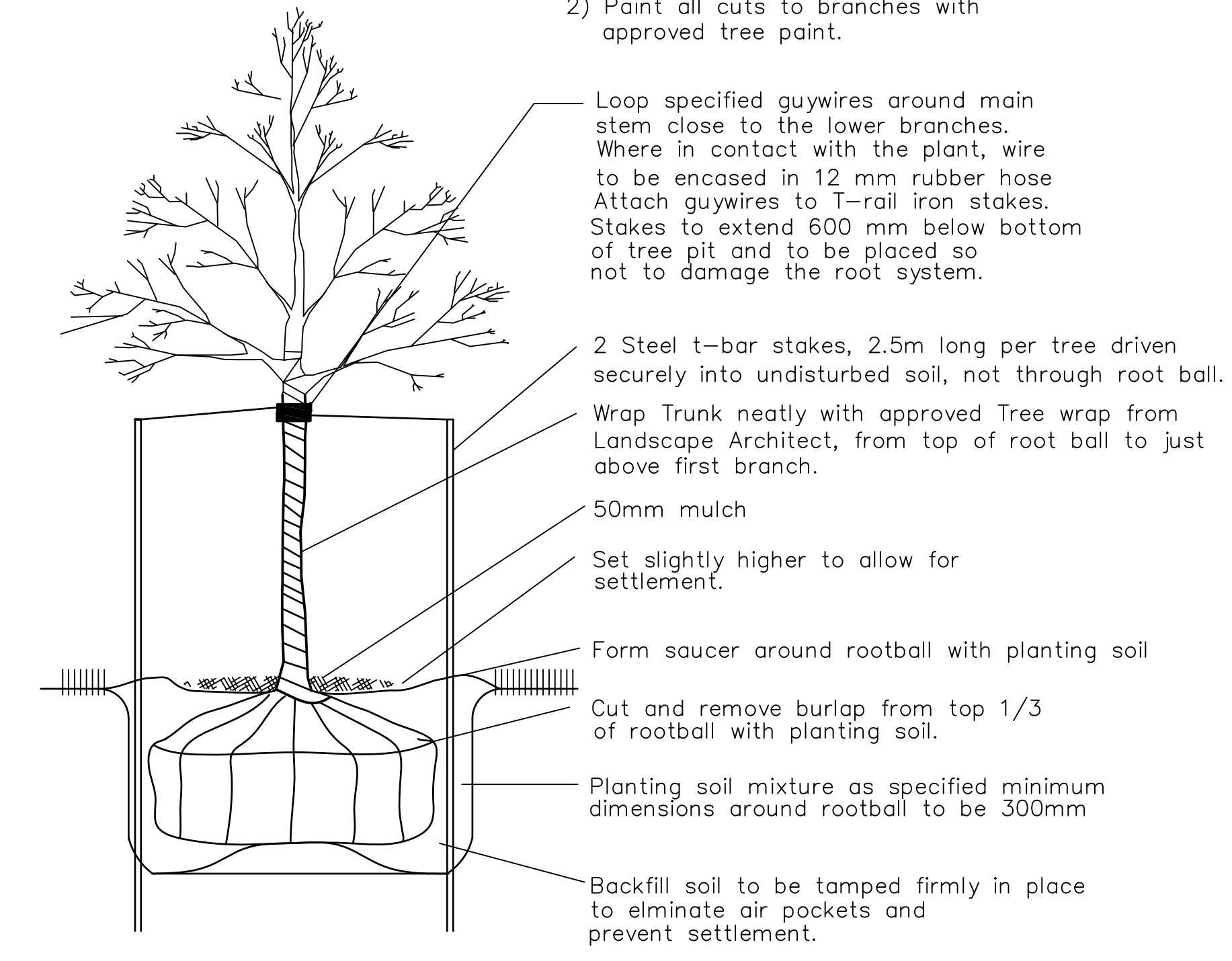

**DECIDUOUS TREE PLANTING**

**Scale**  
Horizontal : 1:250  
Vertical : 1:50

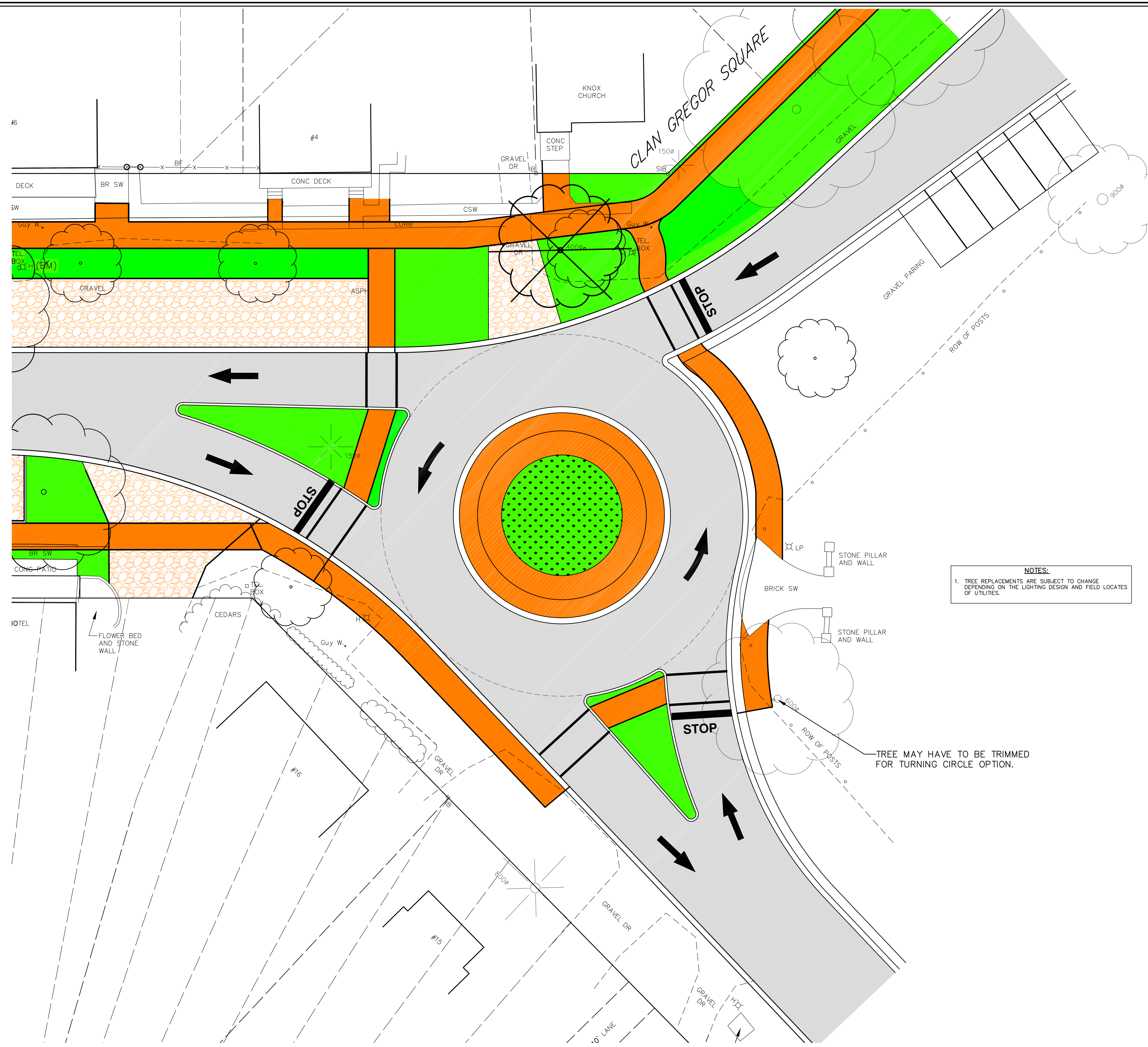

**LEGEND**

SAN. or STM.	EXISTING SEWERS, SANITARY or STORM
M.H. or G.	MANHOLE and CATCHBASIN
W	WATERMAIN
G	GASMAIN
T	UNDERGROUND TELEPHONE
H	UNDERGROUND HYDRO
TV	UNDERGROUND T.V. CABLE
H, B, T, H-B, LP, G, S, P, K	UTILITY POLES
(Symbol)	GRUBING
(Symbol)	REMOVE EXISTING CONC. SIDEWALK AND DRIVES
(Symbol)	REMOVE AND PLACE CONC. SIDEWALK AND DRIVES
(Symbol)	PLACE CONC. SIDEWALK AND DRIVES
(Symbol)	REMOVE EXISTING ASPHALT PAVT
(Symbol)	PLACE HOT MIX ASPHALT (DRIVES 50mm#1.5 HOT MIX MSC.)
(Symbol)	REMOVE EXISTING CONC. CURB

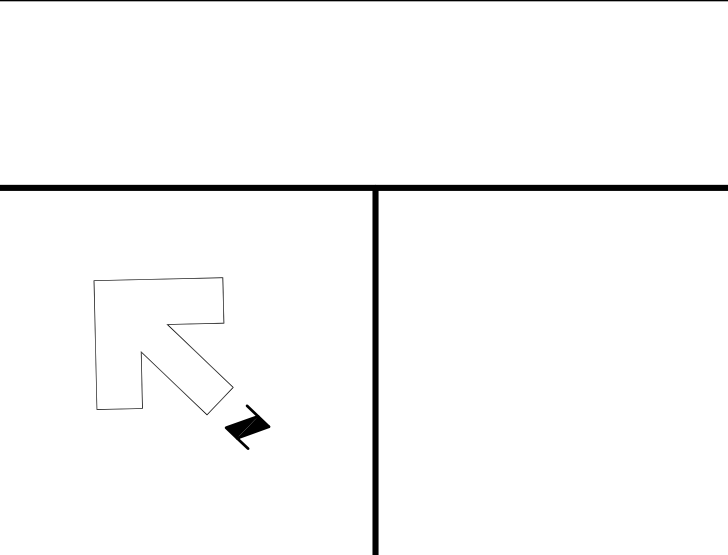

**NOTE**  
The locations of existing underground utilities are shown in an approximate way only and have not been independently verified by the owner or its representative. The contractor shall determine the exact location of all existing utilities before commencing work and agrees to be fully responsible for any damages which might be occasioned by the contractor's failure to exactly locate and preserve any and all underground utilities.

**BENCHMARK INFORMATION**  
? ? ?

**BENCHMARK INFORMATION**  
? ? ?

Design By: JY      Checked By: DLA

**PRELIMINARY**

No.	DATE	REVISION
1	April 20, 2015	Council Presentation
2	Oct. 12, 2015	Updated for PAT Meeting
3	Oct. 19, 2016	Public Open House



Goderich (519) 524-2641      Mount Forest (519) 323-2945



**Municipality of Bluewater**  
**Main Street**  
Option 1  
Plan of Clan Gregor Square and Main Street

**Project No.**  
14106

**Scale**  
1 : 150

**Drawing No.**  
10

**NOTES:**  
1. TREE REPLACEMENTS ARE SUBJECT TO CHANGE DEPENDING ON THE LIGHTING DESIGN AND FIELD LOCATES OF UTILITIES.

TREE MAY HAVE TO BE TRIMMED FOR TURNING CIRCLE OPTION.